

Section 9

75108-xx

**C-Type / Robot Style
Base Gun**



75108 Print List

<u>Print</u>	<u>Page</u>
1. C-type/Robot Style Assembly-Cover	9-3
2. C-type Base Gun Assembly.....	9-4
3. Moveable Arm Assembly.....	9-5
4. 35043 Pin Assembly	9-6
5. Stationary/Equalizer Assembly	9-7
6. 88016 Equalizer Assembly -Sht #1	9-8
7. 88016 Equalizer Assembly -Sht #2	9-9
8. Mounting Bracket Assembly.....	9-10
9. 99016 Rod Boot Assembly	9-11



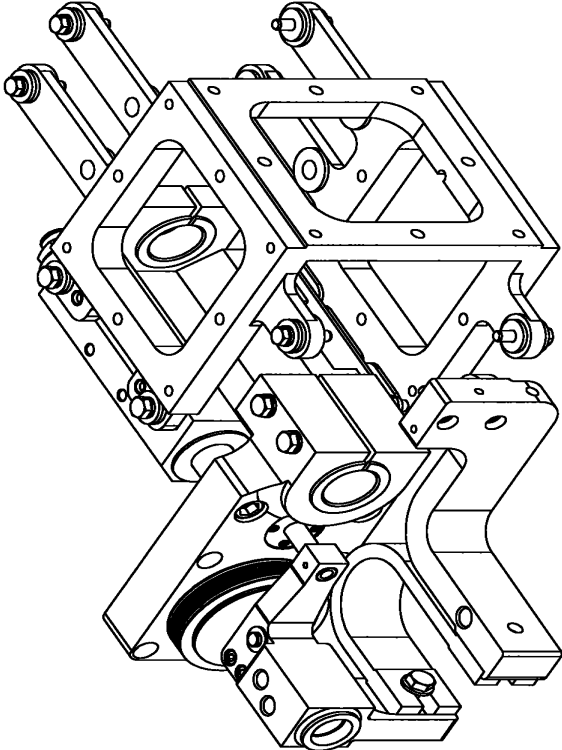

GROSSEL TOOL CO.
C-TYPE / ROBOT STYLE
BASE GUN ASSEMBLY
"75108"

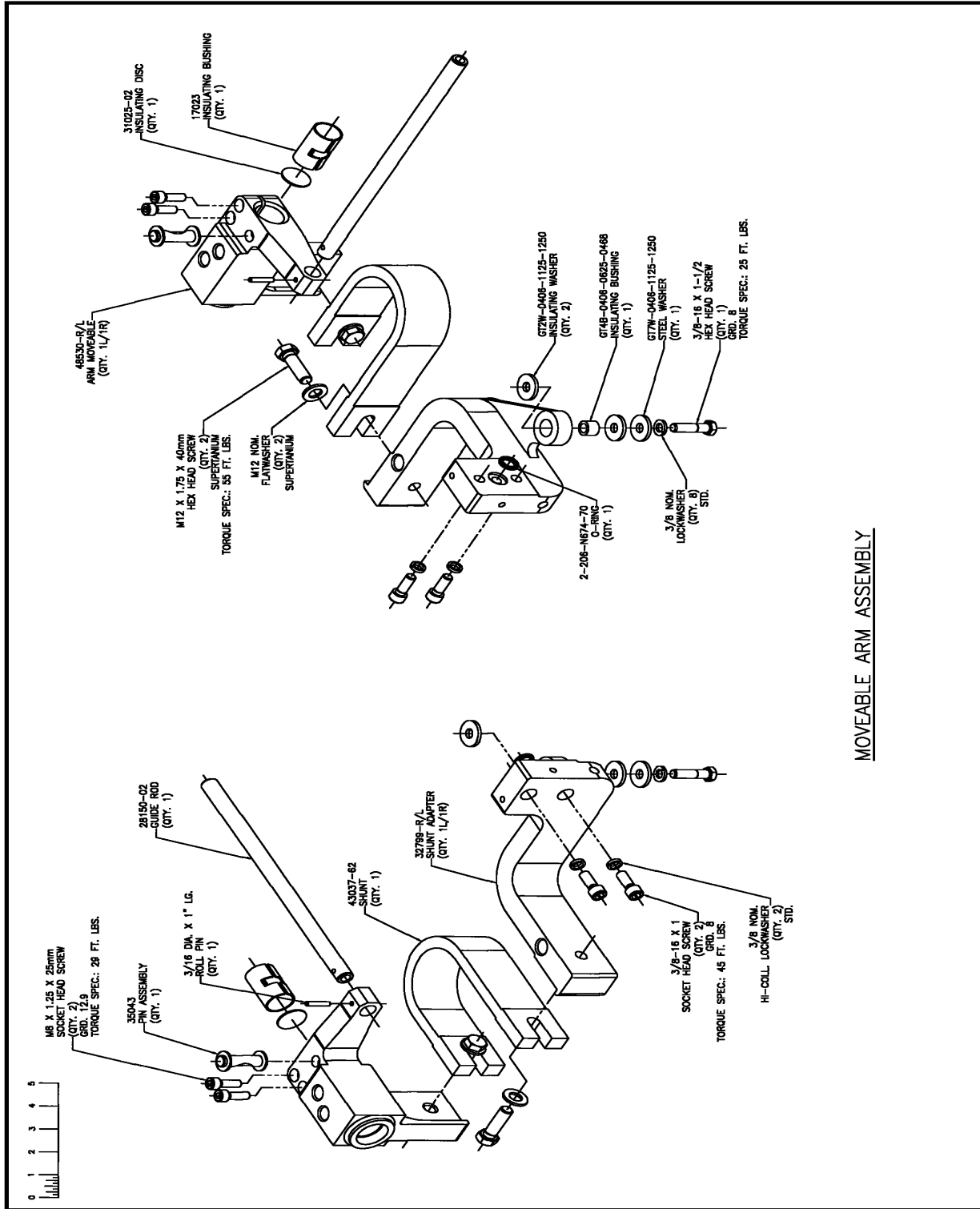

MOVEABLE ARM ASSEMBLY



GROSSEF TOOL COMPANY

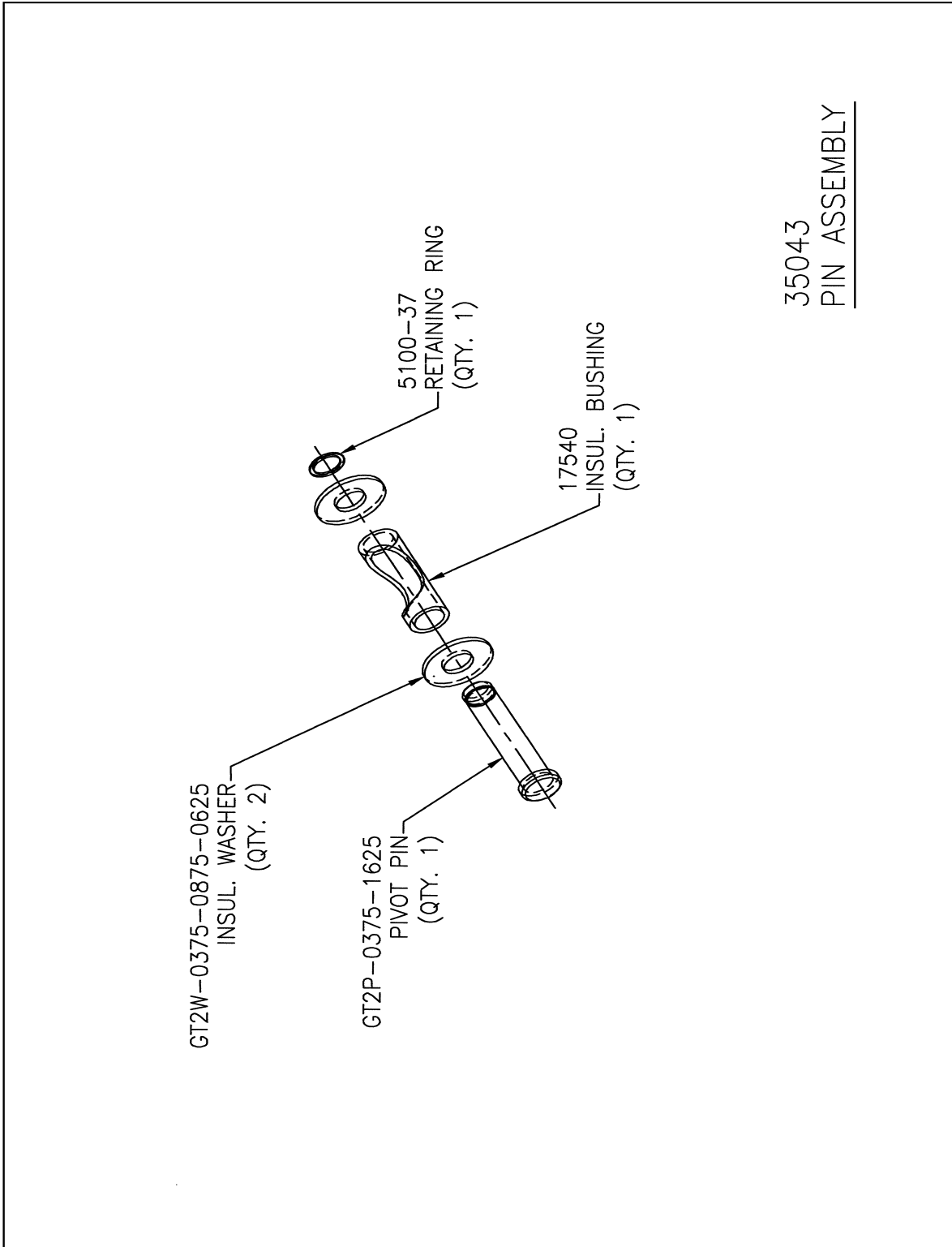

Grossel Tool
Modular Base Gun Assembly MANUAL

SECTION 9: 75108-XX

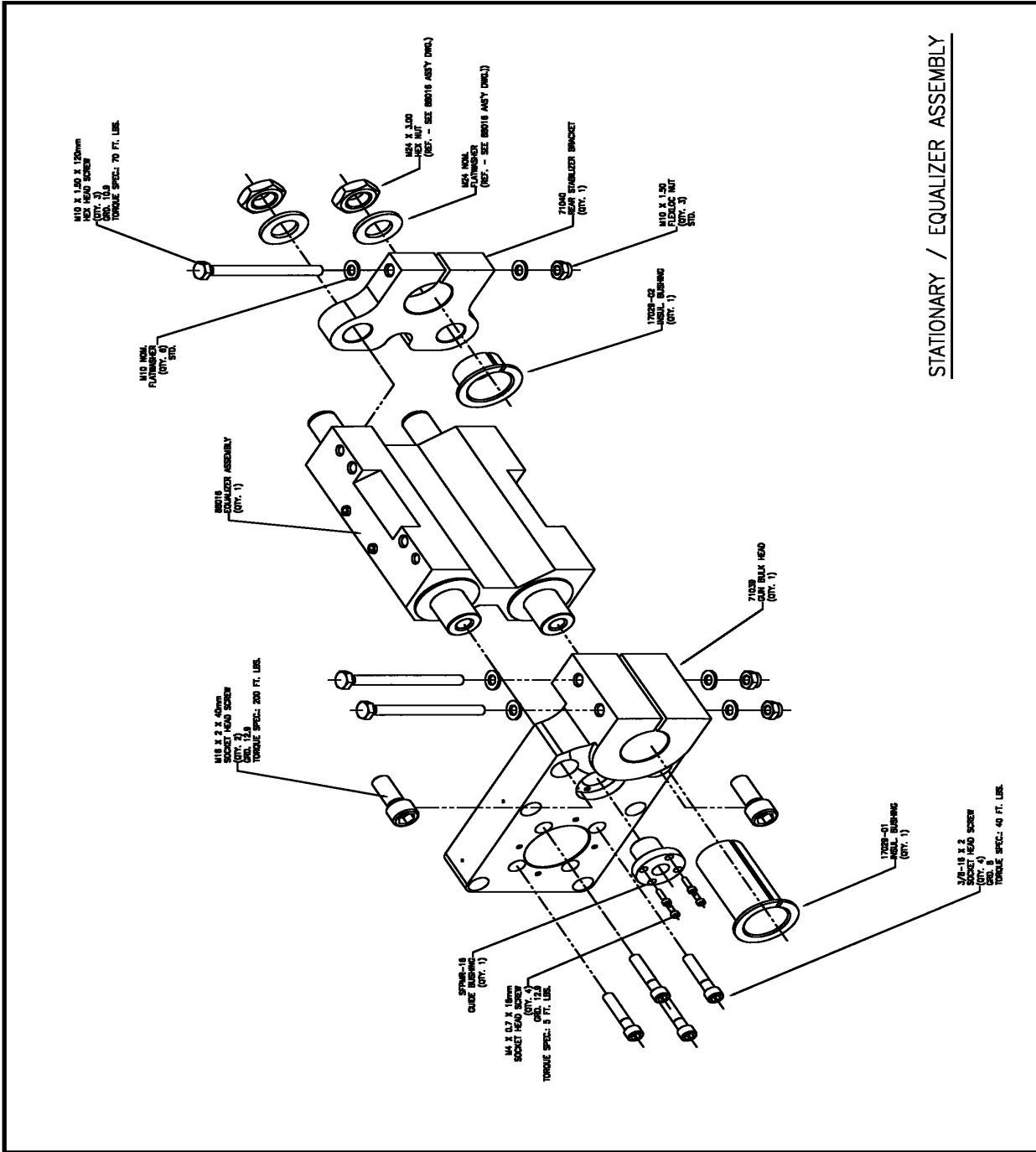

STATIONARY / EQUALIZER ASSEMBLY



Grossel Tool
Modular Base Gun Assembly MANUAL

SECTION 9: 75108-XX

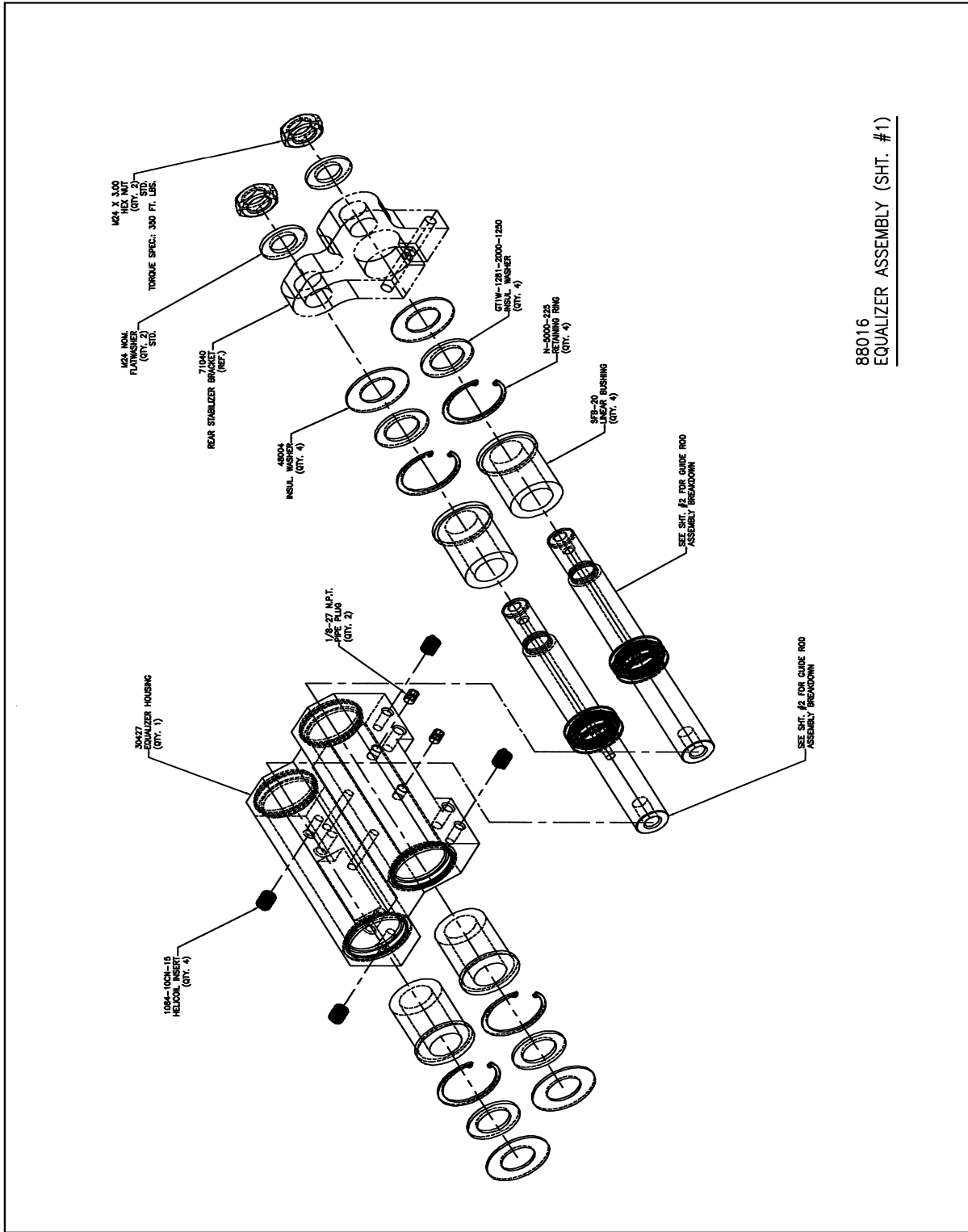

88016
EQUALIZER ASSEMBLY (SHT. #1)



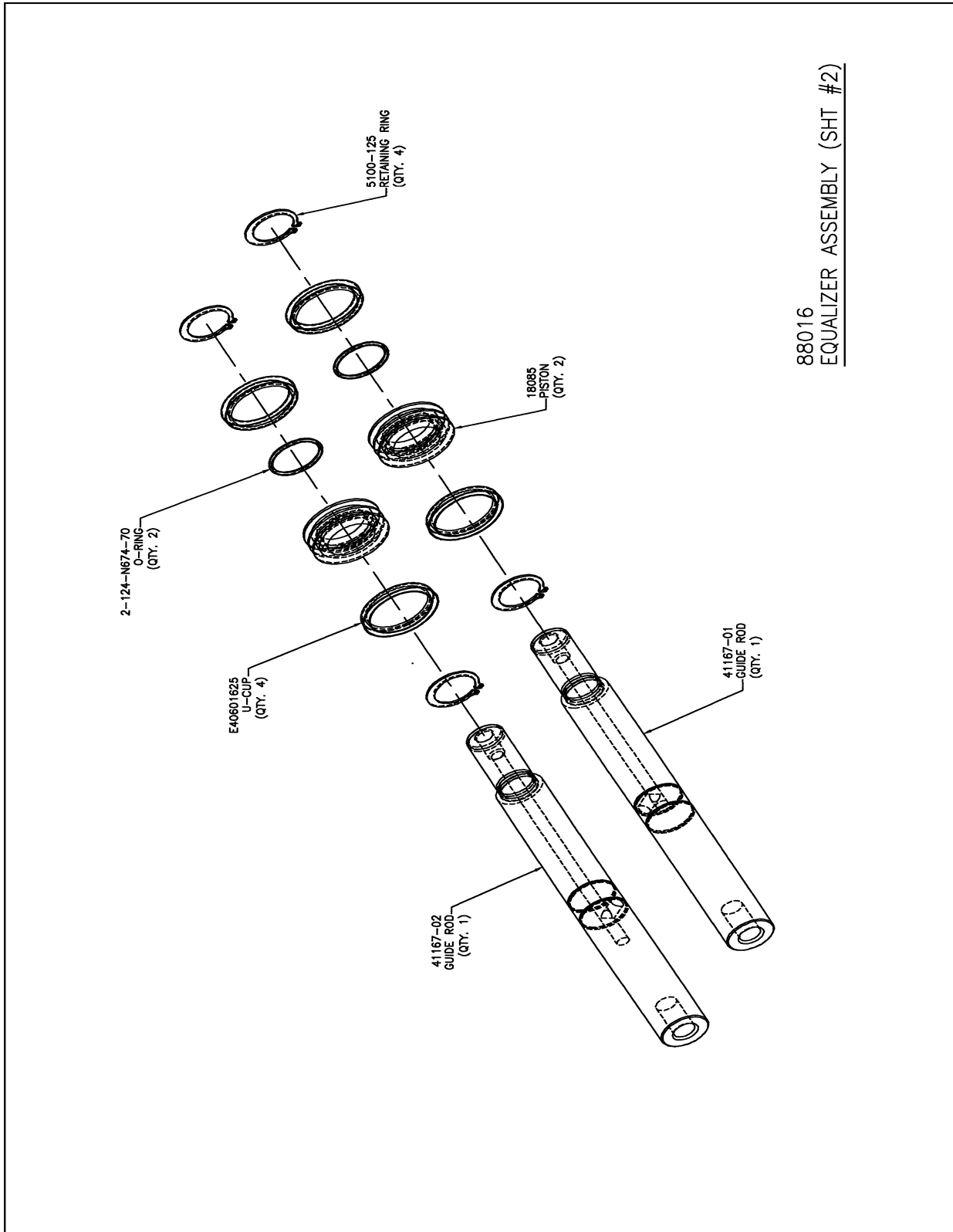

88016
EQUALIZER ASSEMBLY (SHT #2)

Grossel Tool Modular Base Gun Assembly MANUAL

SECTION 9: 75108-XX

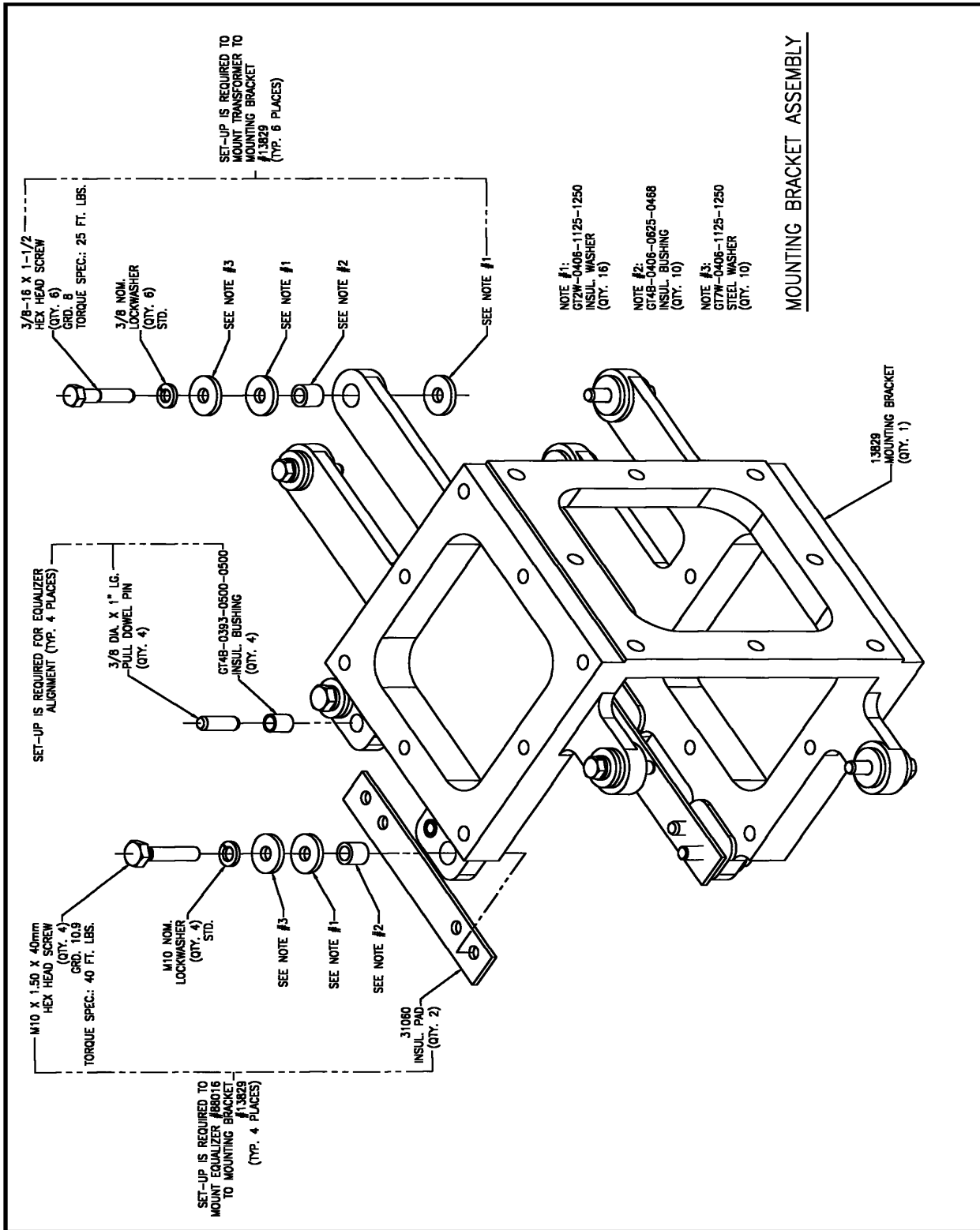

GROSSEL TOOL COMPANY

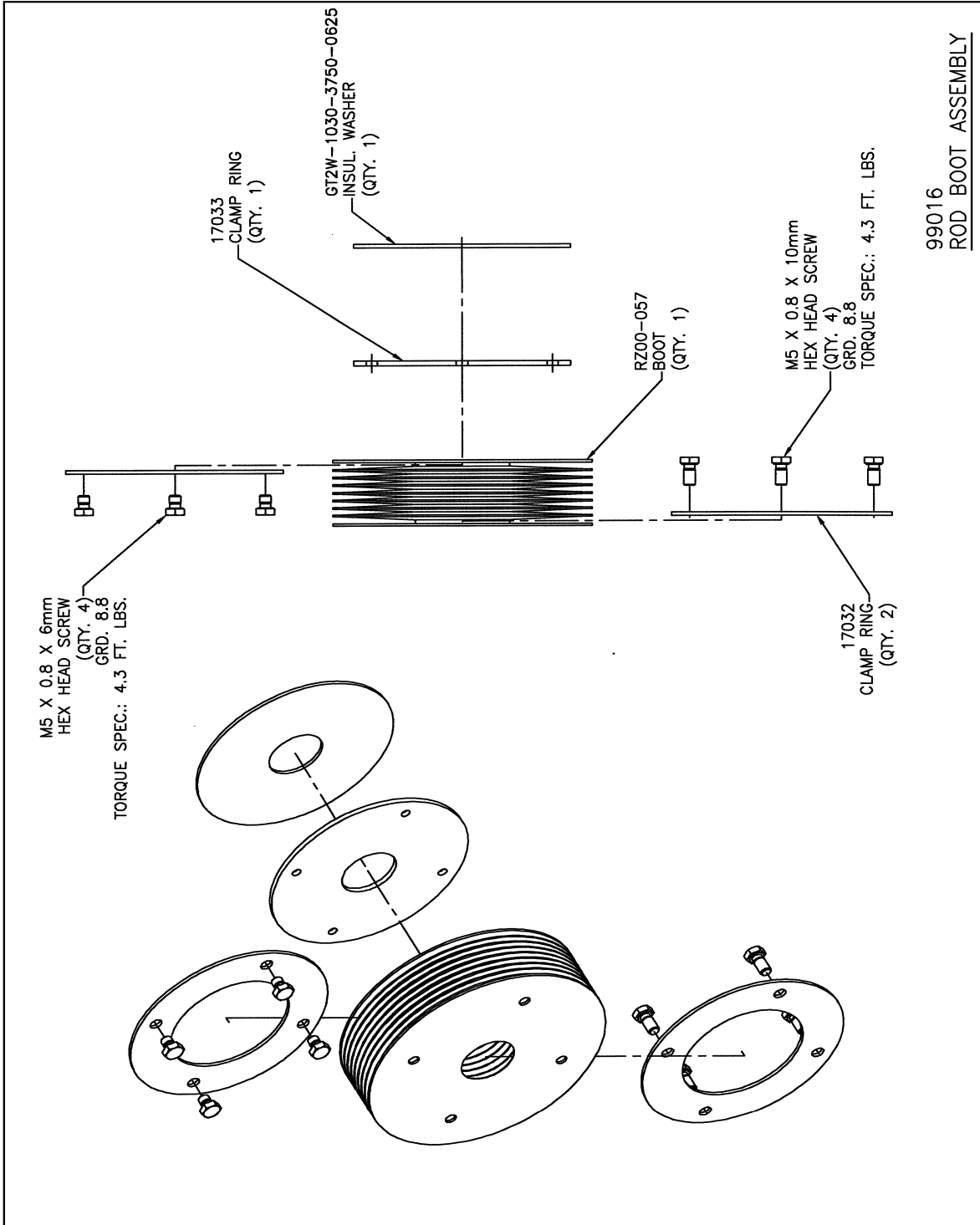

99016
 ROD BOOT ASSEMBLY

